

inédit

LIGHTING

shuffle

design by michel vyvey

SHUFFLE is a built-in spot system with two light sources on a single plate.

The socket tubes can be set deep into the plate or pushed into a more downwards position, according to your personal preference. This ensures that the beams of light are adjustable, whatever light source you choose. The standard sockets are cylindrical in form, but there is also a version with a bevelled edge, which offers a wider range of lighting variations.





la scala pizzeria (nieuwpoort, belgium) by anis patry & rupp designer, photo by philp braem

shuffle 230V surfaced

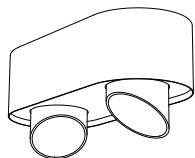

lamp type	retrofit LED
fitting	GZ10
max. watt	2 x 10W
voltage	230V
class	1
gear	-
length	227 mm
width	102 mm
height	65/86 mm

order code

white	T49S5HWL
black	T49S5HZL

shuffle 230V

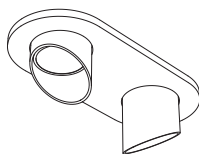

lamp type	retrofit LED
fitting	GZ10
max. watt	2 x 10W
voltage	230V
class	1
gear	-
length	225 mm
width	100 mm
height	8/86 mm

order code

white	T49S2HWL
black	T49S2HZL